



Preferred Fluvial Option

Public Consultation Day

13<sup>th</sup> April 2023



OPW  
Oifige na hOibreacha Poblaithe  
Office of Public Works



# Presentation Schedule

- Project Team
- Recap on scheme status
- Decision making process
- Preferred Option
- Questions/ Discussions



# Project Team



- Clare County Council
- OPW
- JBA Consulting/JB Barry and Partners JV
- Various subconsultants and subcontractors

Clare County Council appointed the JBA Consulting/JB Barry JV team to assess, develop and design a **sustainable** flood relief scheme for Kilkee to a determined **Standard of Protection** that is **technically, socially, environmentally** and **economically** acceptable.



# Scheme Status Update

- In latter stages of Stage 1 (of 5)
- Four emerging options for the Victoria Stream and three emerging options for the Atlantic Stream were presented in August 2022
- Feedback from previous PPD incorporated into decision making
- Preferred Option has been chosen

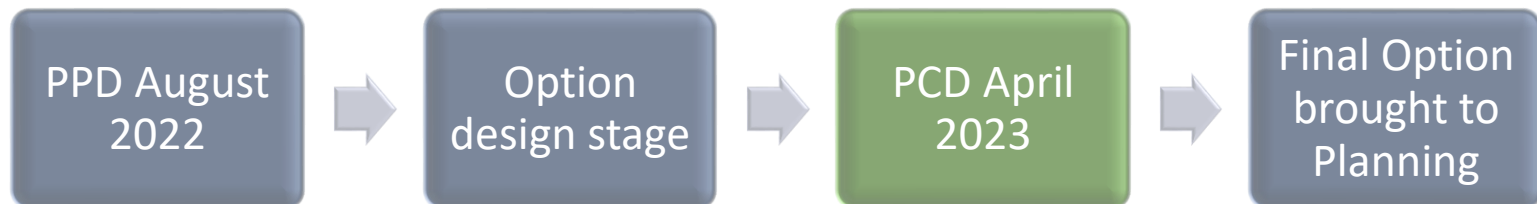

# Decision Making Process

- Each of the Options were assessed based on cost and by assessment through a Multi-Criteria Assessment process
- This MCA assessment scores each of the options under the following headings

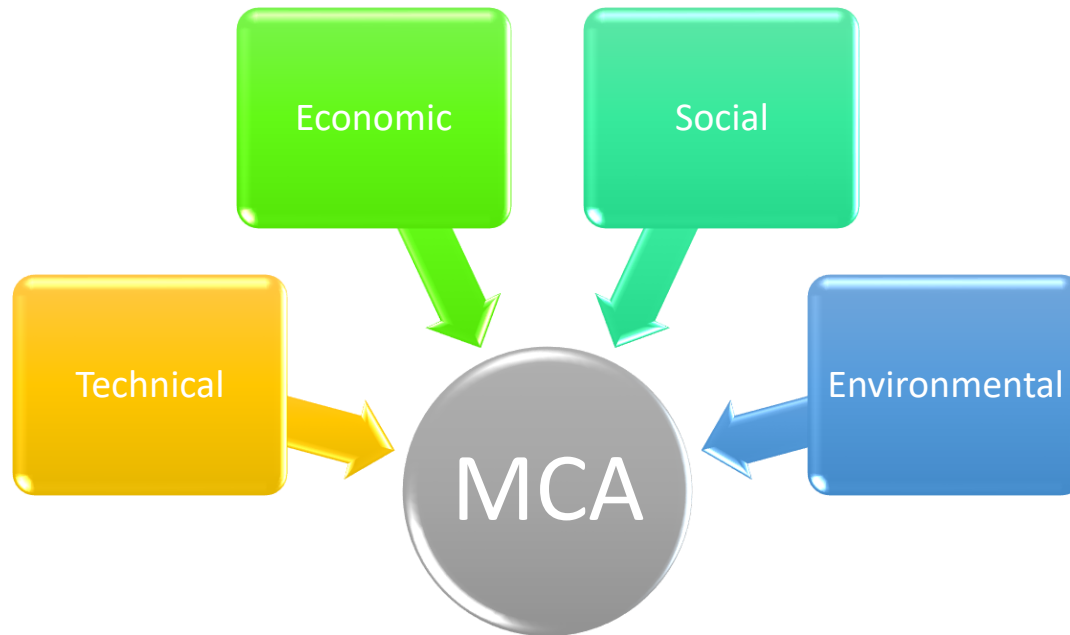



# Atlantic Stream Preferred Option

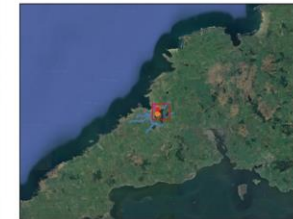

Atlantic Stream Option 1

### Legend

- Bunding
- UpgradeScreen
- Wall Increase
- Areas benefiting from Option
- Flood Extents increased from option
- No change in flood extents



Drawn By: CD Date: 05/07/2022 Scale: 1:3,584  
Checked By: CJW Date: 05/07/2022 Original at A2  
Approved By: CJW Date: 05/07/2022  
Status: S1 Revision: P01  
Figure Title: Atlantic Stream Option 1

Contains OS data © Crown copyright and database right (2022)



COMHAIRLE CONTAE AN CHLÁIR  
CLARE COUNTY COUNCIL



**OPW** Oifig na  
nOibreacha Poiblí  
Office of Public Works



**BARRY**  
& PARTNERS  
consulting engineers

# Atlantic Stream Preferred Option

## AREA 4 – KILKEE BAY HOTEL

- Realignment of existing stream
- New 1.6m high earth embankment
- Depth of water in 100 year event: 1-1.2m

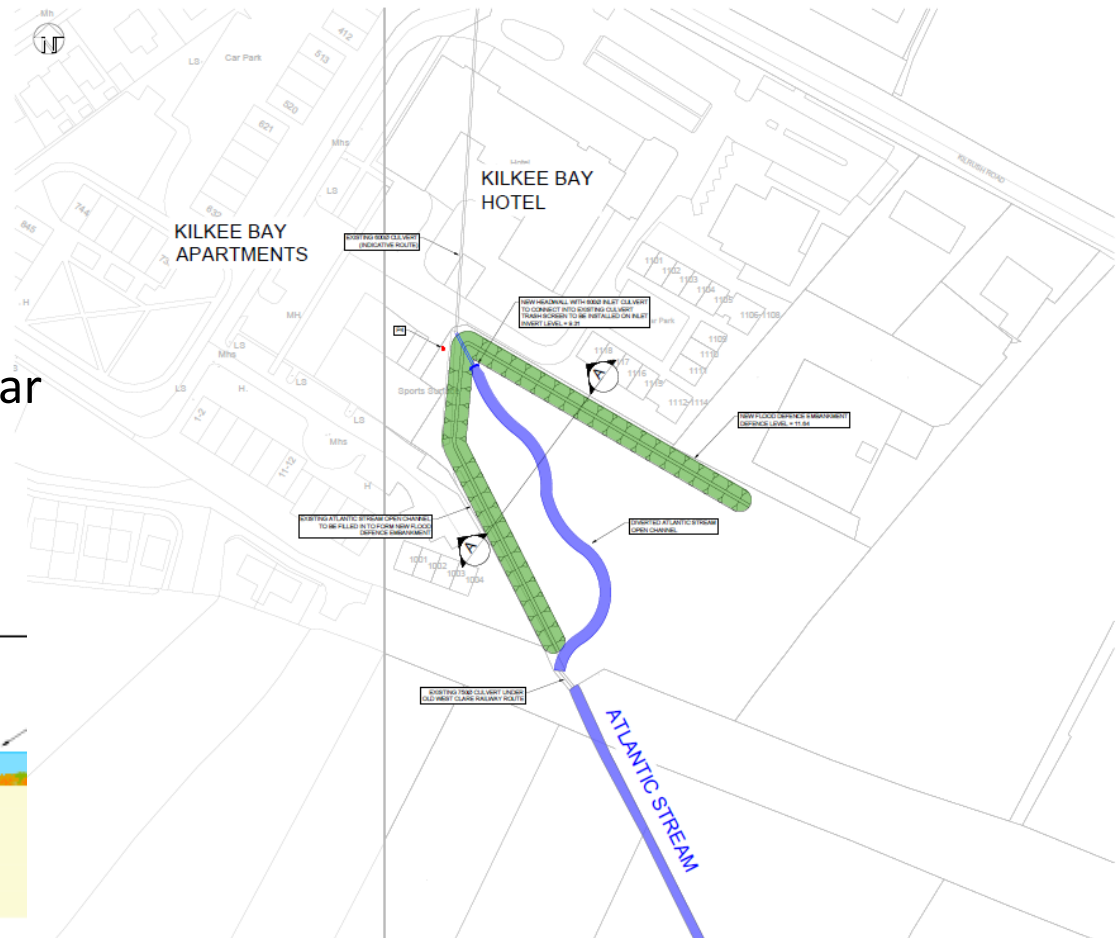
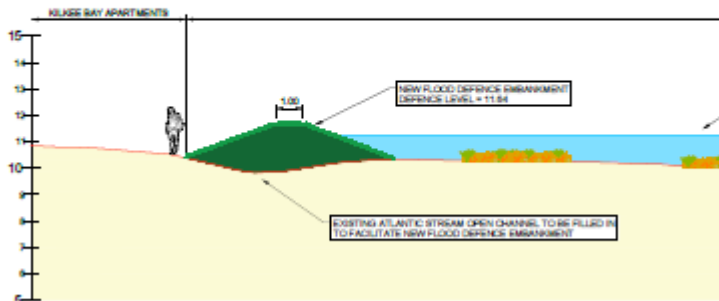

# Atlantic Stream Preferred Option

## AREA 5 – DUN AN OIR ESTATE

- New earth embankment at Sandpark
- New 0.7m high earth embankment
- Increase in wall height at rear of properties by circa. 300mm

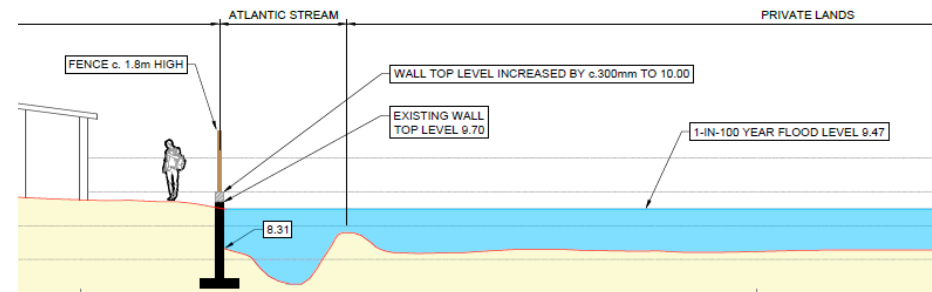
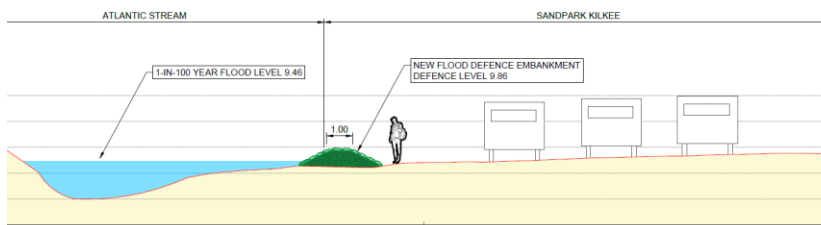
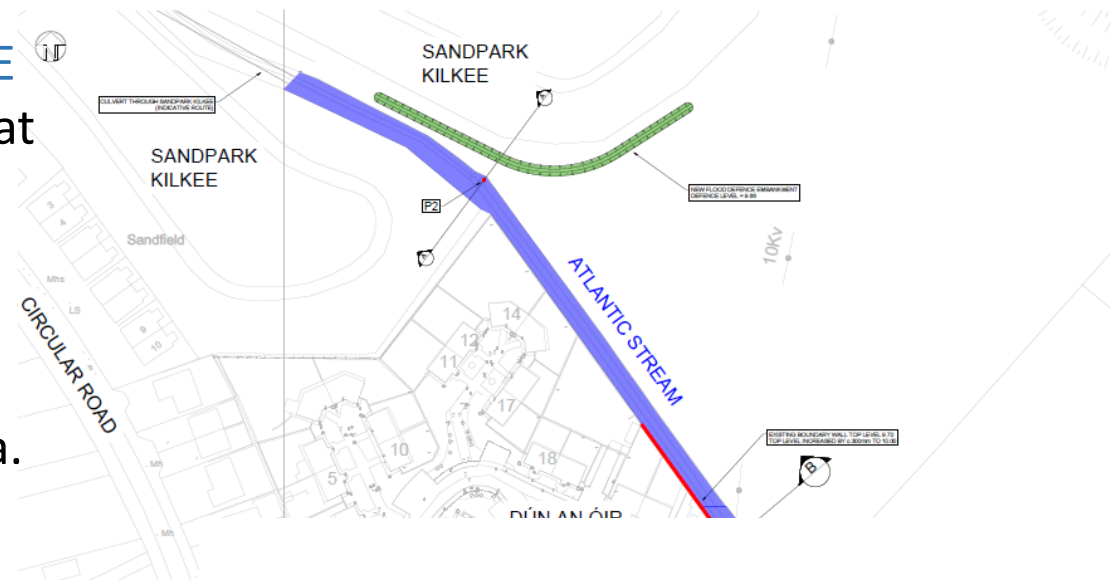



# Atlantic Stream Preferred Option

## AREA 6 – WATERWORLD

- New trash screen at inlet to culvert
- Amendment of existing overflow manhole on promenade

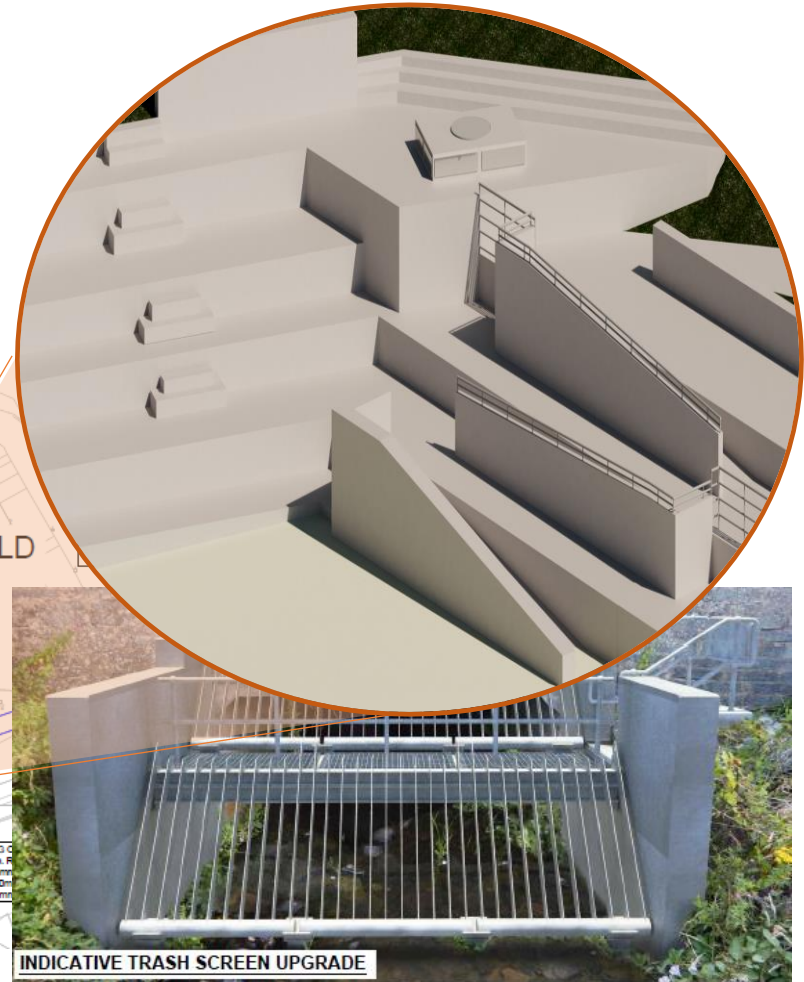
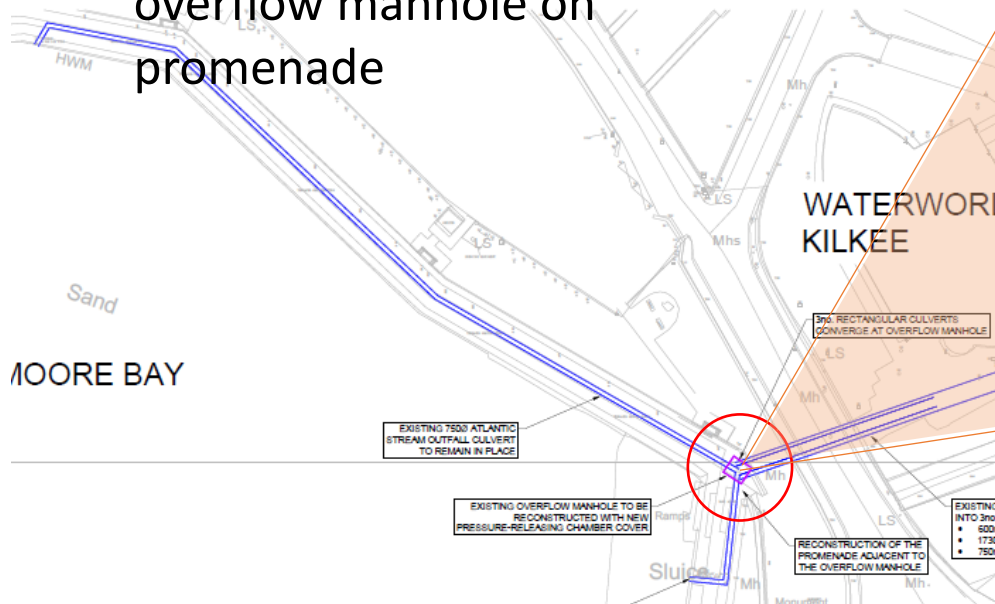



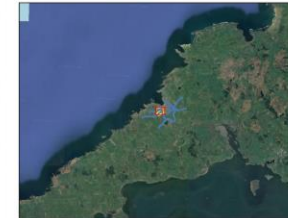
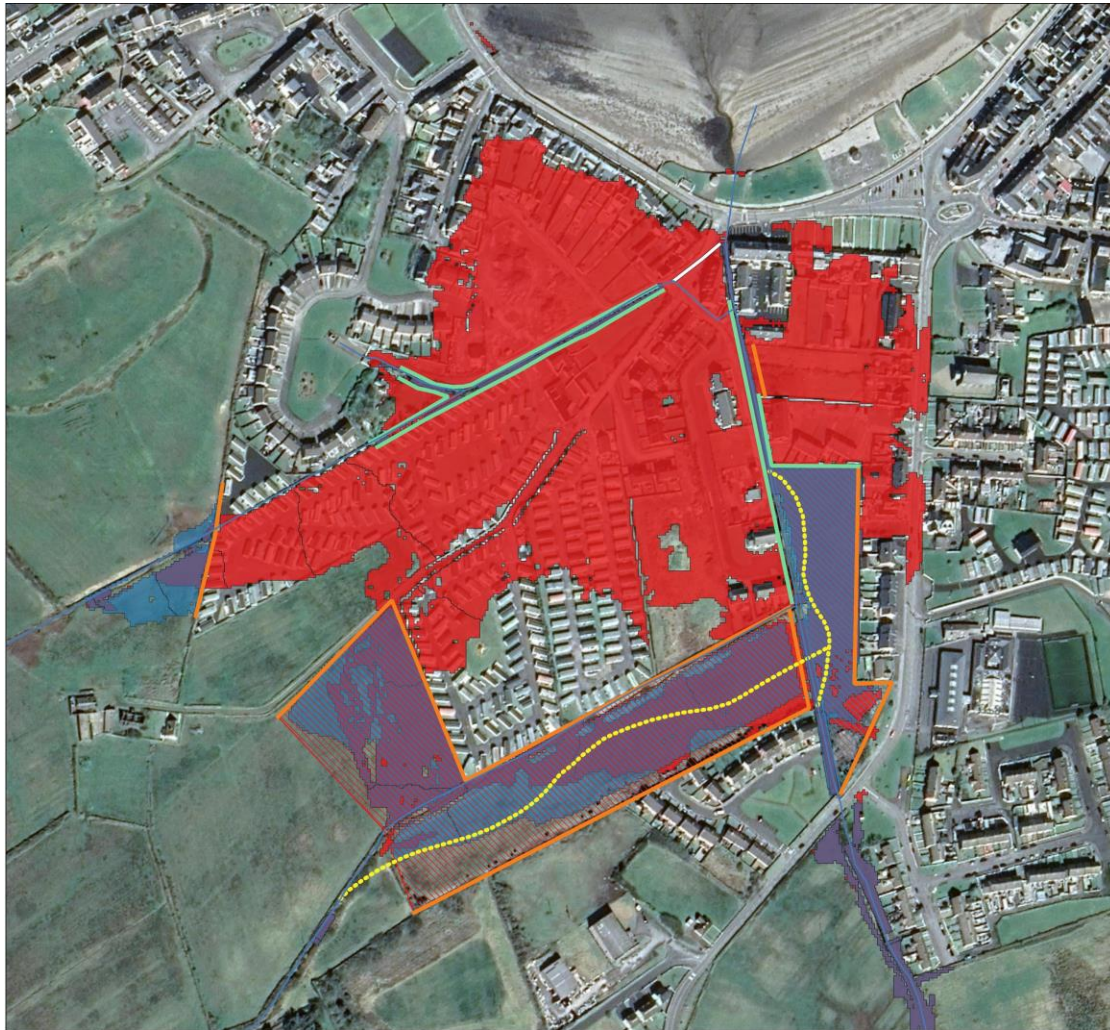





# Victoria Stream Preferred Option

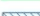

Victoria Stream Option 1

### Legend

-  Channel Diversion
-  Channel realignment
-  Embankment
-  Wall
-  Retained Floodplain
-  Storage
-  Flood Extents increased by Option
-  Areas benefiting from option
-  No change in flood extents



Drawn By: CD Date: 05/07/2022 Scale: 1:1,792  
 Checked By: CJW Date: 05/07/2022 Original at A2  
 Approved By: CJW Date: 05/07/2022  
 Status: S1 Revision: P01  
 Figure Title: Victoria Stream Option 1

Contains OS data © Crown copyright and database right (2022)





# Victoria Stream Preferred Option

## AREA 1 – WELL ROAD

- New 1m Embankment upstream of Well Field
- Existing stream to be upgraded to concrete channel

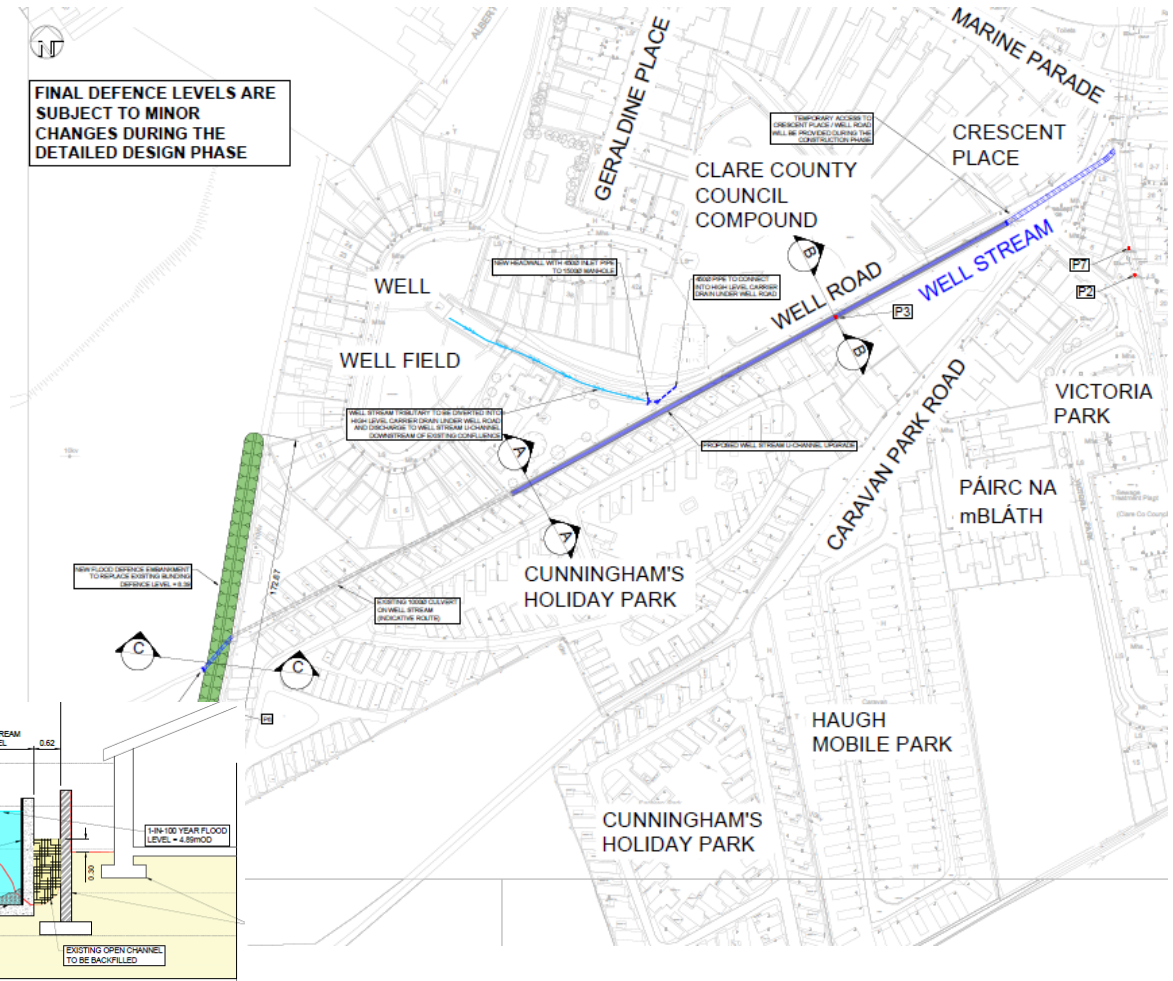

# Victoria Stream Preferred Option

## AREA 2 – VICTORIA COURT

- New culvert connecting Well Stream to Victoria Stream
- New 0.8m Earth Embankment on opposite bank of Victoria Park
- New wall at property 20 Victoria Court
- New flood defence wall on Victoria Park bank

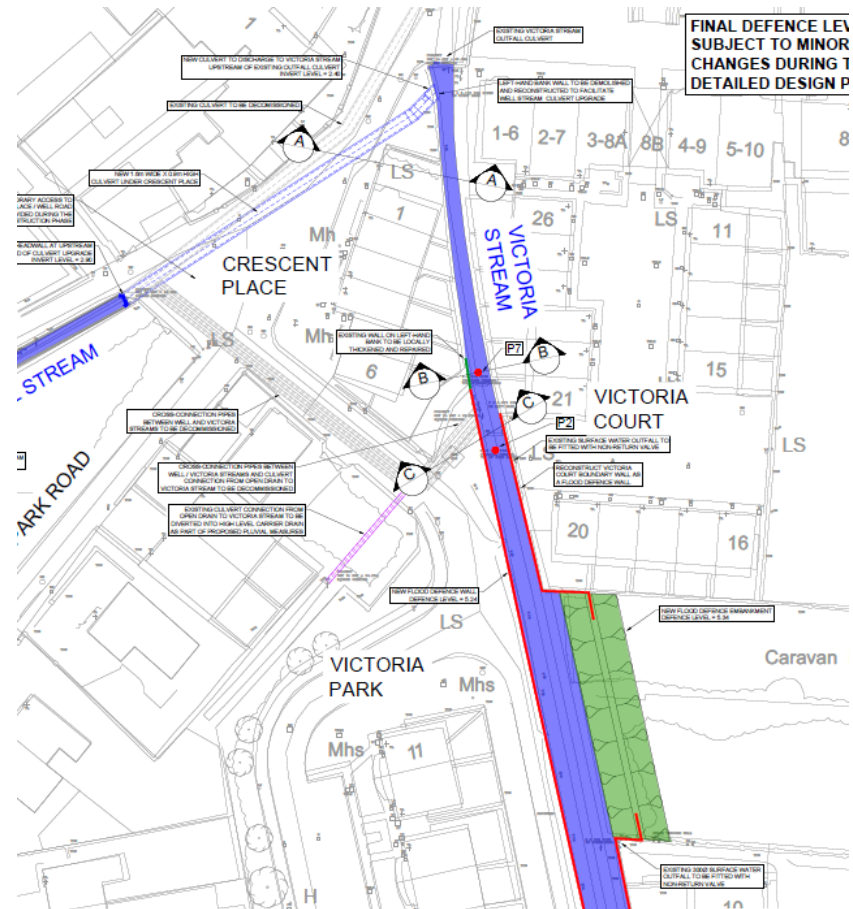

# Victoria Stream Preferred Option

## AREA 2 – VICTORIA COURT

- New culvert connecting Well Stream to Victoria Stream
- New 0.8m Earth Embankment on opposite bank of Victoria Park
- New wall at property 20 Victoria Court
- New flood defence wall on Victoria Park bank

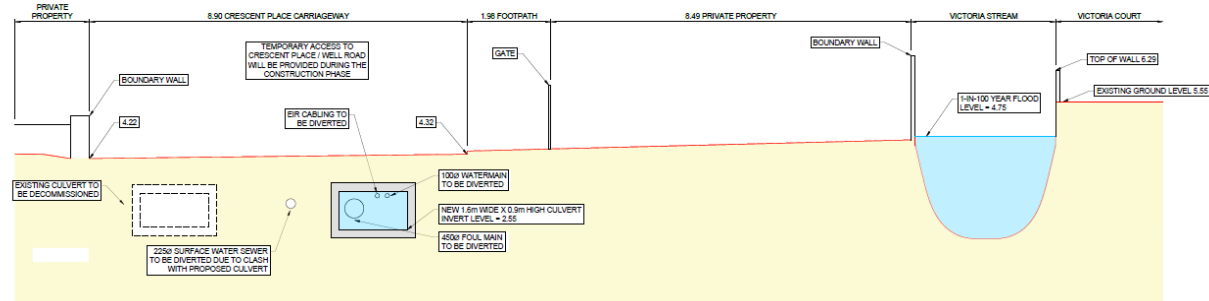
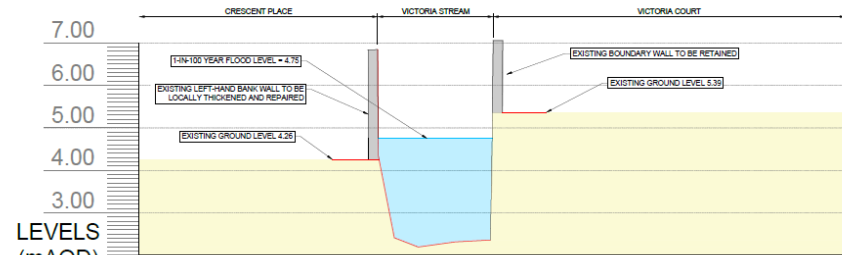
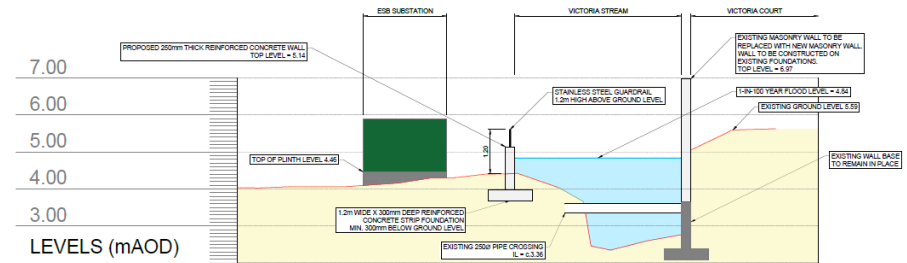



# Victoria Stream Preferred Option

## AREA 3 – WETLAND/CHURCH ROAD

- Earth Embankments on perimeter of new wetland
- Realigned western tributary stream and Victoria Stream
- Rebuild of Victoria Crescent boundary walls
- Water quality and

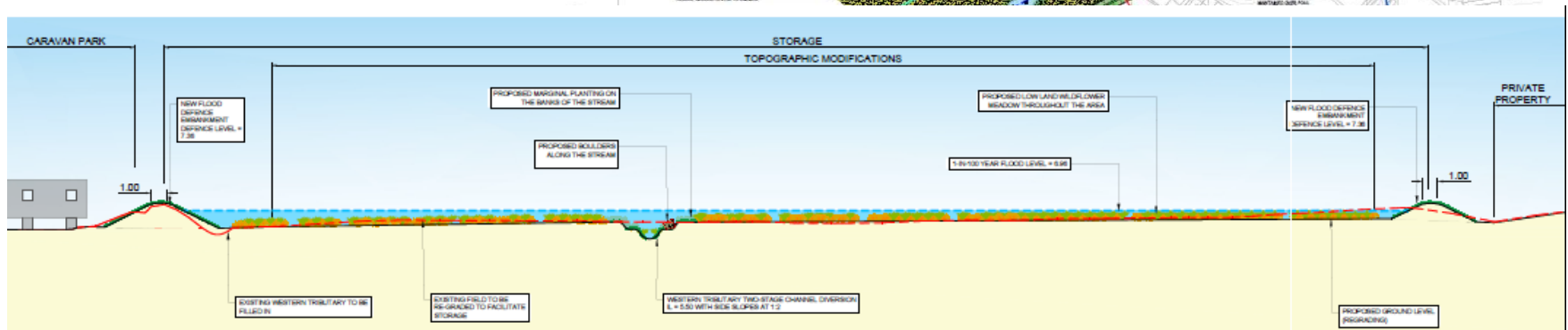
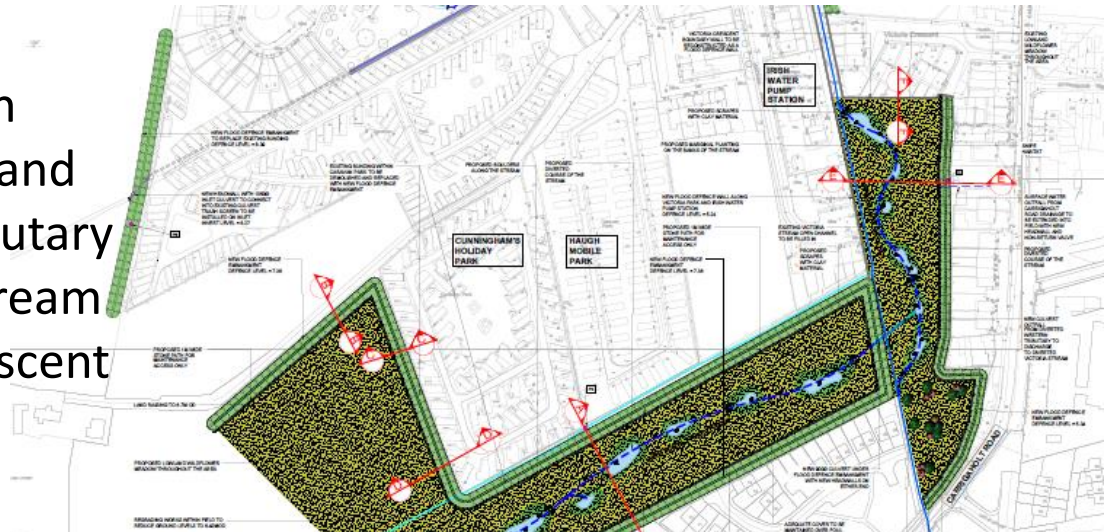

# Pluvial Scheme

- Storage of stormwater is required as part of the scheme to prevent pluvial flooding from occurring as a result of surcharged networks
- Storage areas and pump stations are required as part of all three options

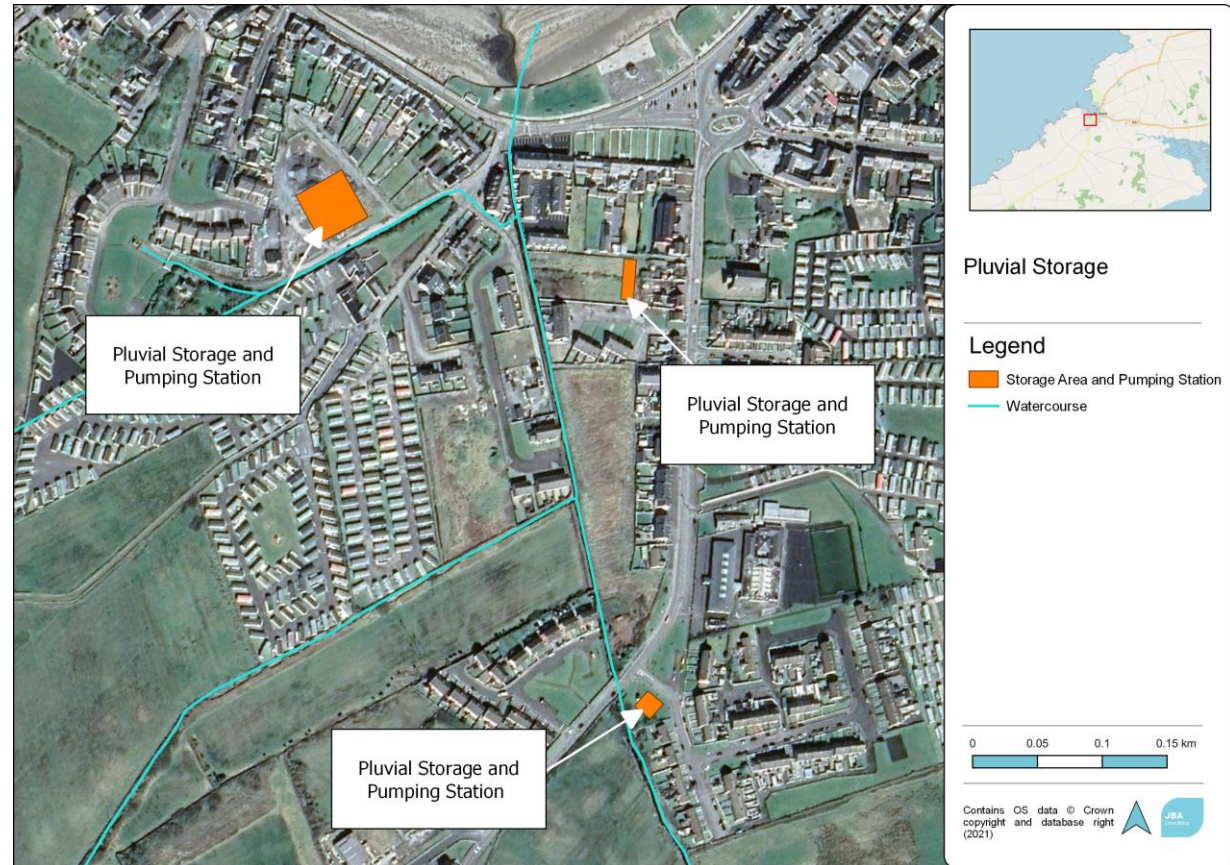



# Coastal Scheme

- Being progressed independently to fluvial scheme
- Work done so far:
  - Beach surveys to assess sand depth changes
  - Coastal wave and water level modelling study
  - Wave impact assessments of existing structures ongoing

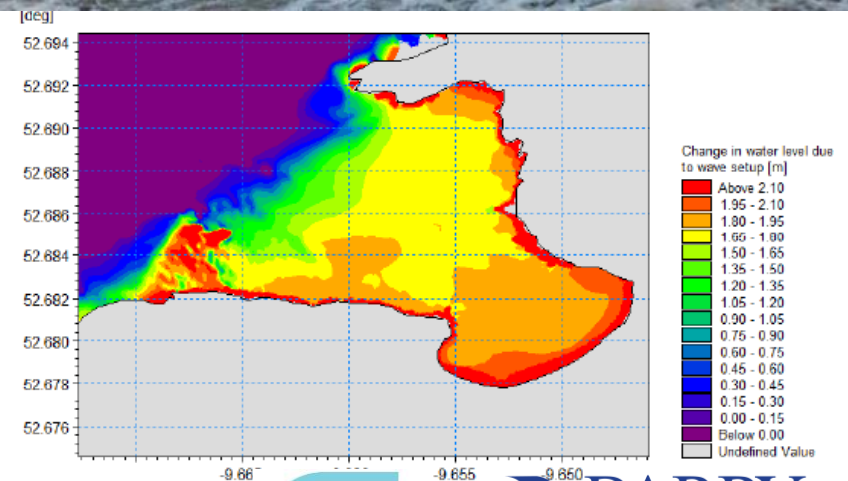

# What next?

# Planning Road Map





# Estimated Construction Timeframe

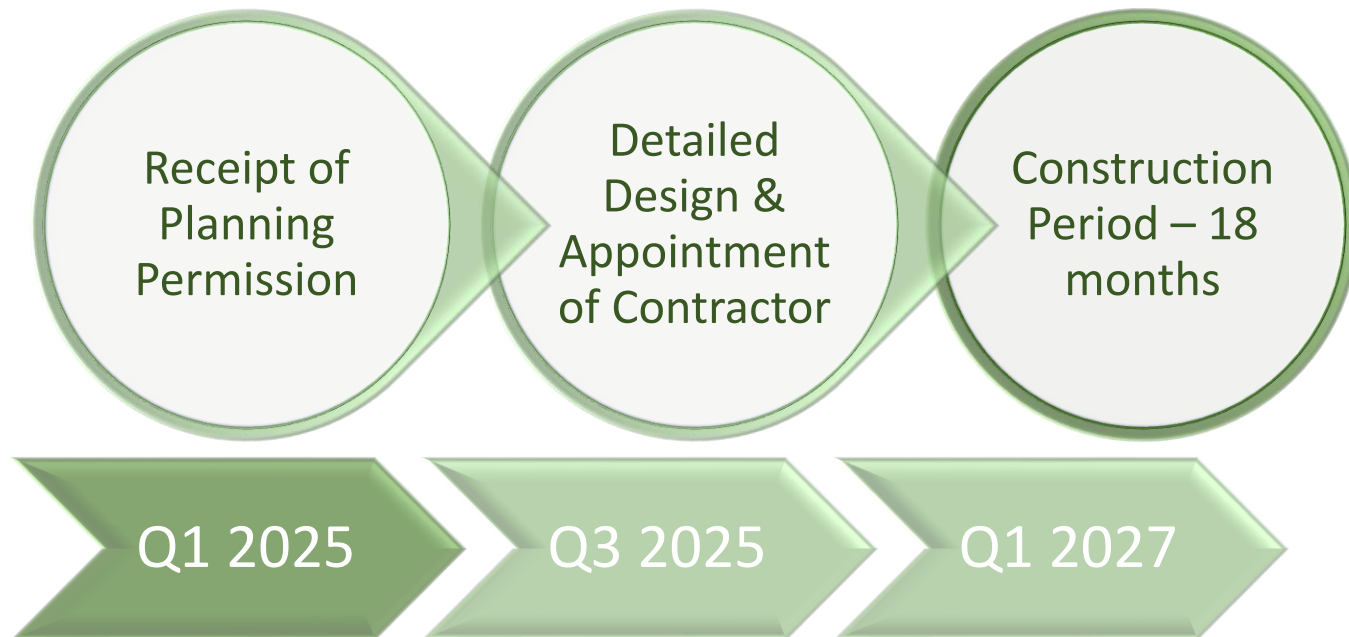

# Your opportunities to take part



- At this stage of the project it is important that we have the opportunity to listen to the views of those who will be living and working near the scheme
- Questionnaire forms are available and can be completed today or returned by 28<sup>th</sup> April where possible
- You can also find out more about the project in the following places and queries or comments raised through these media:

Website

[www.kilkeefrs.ie](http://www.kilkeefrs.ie)

Email

[info@kilkeefrs.ie](mailto:info@kilkeefrs.ie)



# Thank you

# Any Questions?



COMHAIRLE CONTAE AN CHLÁIR  
CLARE COUNTY COUNCIL



**OPW**

Oifig na  
nOibreacha Poiblí  
Office of Public Works



**BARRY**  
& PARTNERS  
consulting engineers