

1

2

No.	Construction Risk	Maintenance Risk	Demolition Risk
In addition to the hazards/risks normally associated with the types of work detailed on this drawing take note of the above.			

SAFETY, HEALTH AND ENVIRONMENTAL INFORMATION BOX

DRAWING NOTES

1.

ALL DIMENSIONS SHOWN ARE IN METRES UNLESS OTHERWISE STATED AND LEVELS IN METRES TO ORDNANCE DATUM.

2.

DO NOT SCALE FROM THIS DRAWING. ALL DIMENSIONS MUST BE CHECKED/VERIFIED ON SITE.

3.

ANY DISCREPANCIES NOTED ON SITE ARE TO BE REPORTED TO THE ENGINEER IMMEDIATELY.

4.

THE LOCATIONS OF ANY KNOWN SERVICES SHOWN ON THIS DRAWING ARE APPROXIMATE AND FOR GUIDANCE ONLY. THE CONTRACTOR WILL CONFIRM THE LOCATION OF ANY SERVICES PRIOR TO THE COMMENCEMENT OF ANY WORKS.

5.

THE ELECTRONIC VERSION OF THIS DRAWING IS NOT TO BE USED FOR SETTING OUT.

REFERENCE DRAWINGS

19109-JBAI-XX-XX-DR-C-02115 KILKEE BAY HOTEL CROSS-SECTIONS

PREFERRED FLUVIAL OPTION			
REPORTING POINT LOCATION	1% AEP FLOOD LEVEL (mOD)	EMBANKMENT LEVEL (mOD)	FLOOD WALL LEVEL (mOD)
P1 (ENTRANCE TO ATLANTIC CULVERT AT WATERWORLD KILKEE)	7.05	-	-
P2 (SANDPARK KILKEE)	9.46	9.86	-
P3 (DÚN AN ÓIR ESTATE)	9.47	-	9.77
P4 (KILKEE BAY HOTEL)	11.24	11.64	-

LEGEND

NEW FLOOD DEFENCE EMBANKMENT

WATER LEVEL REPORTING POINT

STREAM

FINAL DEFENCE LEVELS MAY BE SUBJECT TO MINOR CHANGES DURING THE DETAILED DESIGN PHASE

P03	Comments	FOR PUBLIC CONSULTATION DAY.									
Rev.:	Date	11/04/23	Drawn	PB	Designed	PB	Checked	MOD	Approved	CW	
P02	Comments	FOR PUBLIC CONSULTATION DAY.									
Rev.:	Date	07/04/23	Drawn	PB	Designed	PB	Checked	MOD	Approved	CW	
P01	Comments	FOR CLIENT REVIEW.									
Rev.:	Date	06/04/23	Drawn	PB	Designed	PB	Checked	MOD	Approved	CW	

Client Approval

A - Approved

B - Approved with Revisions

C - Do Not Use

24 Grove Island  
Cortally  
Limerick  
Ireland  
V94 312N

DRAFT

JBA consulting

T +353 (0)61 345 463  
E info@jbaconsulting.com  
www.jbaconsulting.com  
Twitter @JBAConsulting

Project

KILKEE FLOOD RELIEF SCHEME

Title

PREFERRED FLUVIAL OPTION  
ATLANTIC STREAM  
KILKEE BAY HOTEL

for

Client

CLARE COUNTY COUNCIL

The property of this drawing and design vested in Jeremy Benn Associates Ltd. It shall not be reproduced in whole or in part, nor disclosed to a third party, without the prior written consent of Jeremy Benn Associates Ltd.

Drawn: PB

06/04/2023

Designed: PB

06/04/2023

Checked: MOD

06/04/2023

Approved: CW

06/04/2023

Project Reference: 2019s1431 / CGD

Scale: 1:500 @ A1

Drawing Number: 19109-JBAI-XX-XX-DR-C-02108

Status: S3

Revision: P03

Sheet Size: A1



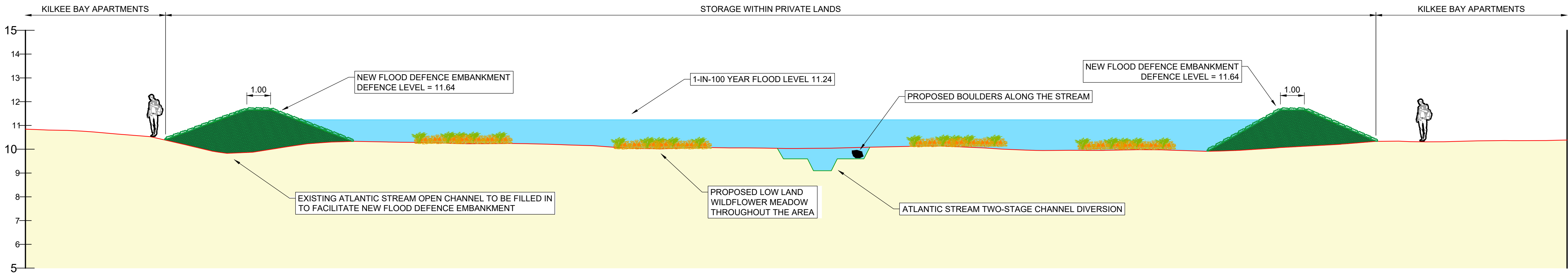

SECTION A-A BEHIND KILKEE BAY HOTEL

1

2

No.	Construction Risk	Maintenance Risk	Demolition Risk
In addition to the hazards/risks normally associated with the types of work detailed on this drawing take note of the above.			

SAFETY, HEALTH AND ENVIRONMENTAL INFORMATION BOX

DRAWING NOTES

1.

ALL DIMENSIONS SHOWN ARE IN METRES UNLESS OTHERWISE STATED AND LEVELS IN METRES TO ORDNANCE DATUM.

2.

DO NOT SCALE FROM THIS DRAWING. ALL DIMENSIONS MUST BE CHECKED/VERIFIED ON SITE.

3.

ANY DISCREPANCIES NOTED ON SITE ARE TO BE REPORTED TO THE ENGINEER IMMEDIATELY.

4.

THE LOCATIONS OF ANY KNOWN SERVICES SHOWN ON THIS DRAWING ARE APPROXIMATE AND FOR GUIDANCE ONLY. THE CONTRACTOR WILL CONFIRM THE LOCATION OF ANY SERVICES PRIOR TO THE COMMENCEMENT OF ANY WORKS.

5.

THE ELECTRONIC VERSION OF THIS DRAWING IS NOT TO BE USED FOR SETTING OUT.

CONTAINS IRISH PUBLIC SECTOR DATA (GEOLOGICAL SURVEY IRELAND & THE OFFICE OF PUBLIC WORKS) LICENSED UNDER A CREATIVE COMMONS ATTRIBUTION 4.0 INTERNATIONAL (CC BY 4.0) LICENCE.

REFERENCE DRAWINGS:

19109-JBAI-XX-XX-DR-C-02108 PREFERRED FLUVIAL OPTION KILKEE BAY HOTEL

LEGEND

EXISTING GROUND LEVEL

PROPOSED GROUND LEVEL

1-IN-100 YEAR FLOOD LEVEL

FINAL DEFENCE LEVELS MAY BE SUBJECT TO MINOR CHANGES DURING THE DETAILED DESIGN PHASE

P03

Comments

FOR PUBLIC CONSULTATION DAY.

Rev.:

Date

11/04/23

Drawn

PB

Designed

PB

Checked

MOD

Approved

CW

P02

Comments

FOR PUBLIC CONSULTATION DAY.

Rev.:

Date

07/04/23

Drawn

PB

Designed

PB

Checked

MOD

Approved

CW

P01

Comments

FOR CLIENT REVIEW.

Rev.:

Date

06/04/23

Drawn

PB

Designed

PB

Checked

MOD

Approved

CW

Client Approval

A - Approved

B - Approved with Revisions

C - Do Not Use

24 Grove Island  
Cortally  
Limerick  
Ireland  
V94 312N

DRAFT

JBA

consulting

T +353 (0)61 345 463  
E info@jbaconsulting.com  
www.jbaconsulting.com  
Twitter @JBAConsulting

Project

KILKEE FLOOD RELIEF SCHEME

Title

PREFERRED FLUVIAL OPTION  
ATLANTIC STREAM  
KILKEE BAY HOTEL CROSS-SECTIONS  
for

Client

CLARE COUNTY COUNCIL

The property of this drawing and design vested in Jeremy Benn Associates Ltd. It shall not be reproduced in whole or in part, nor disclosed to a third party, without the prior written consent of Jeremy Benn Associates Ltd.

Drawn:

PB

06/04/2023

Designed:

PB

06/04/2023

Checked:

MOD

06/04/2023

Approved:

CW

06/04/2023

Project Reference:

2019s1431 / CGD

Scale:

1:100 @ A1

Drawing Number:

19109-JBAI-XX-XX-DR-C-02115

Status:

S3

Revision:

P03

Sheet Size:

A1



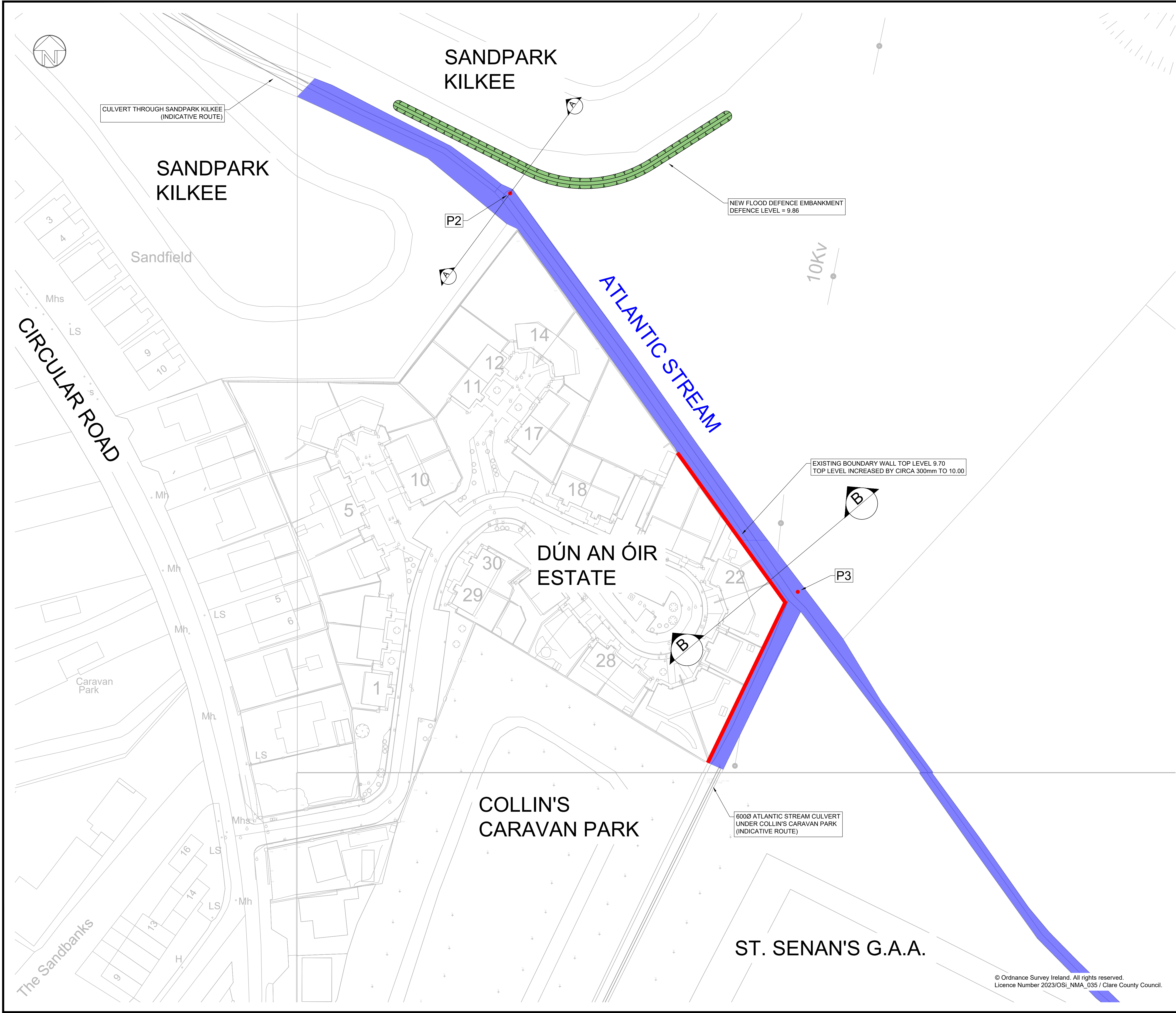

1			
2			
No.	Construction Risk	Maintenance Risk	Demolition Risk
In addition to the hazards/risks normally associated with the types of work detailed on this drawing take note of the above.			

SAFETY, HEALTH AND ENVIRONMENTAL INFORMATION BOX

- DRAWING NOTES**
- ALL DIMENSIONS SHOWN ARE IN METRES UNLESS OTHERWISE STATED AND LEVELS IN METRES TO ORDNANCE DATUM.
  - DO NOT SCALE FROM THIS DRAWING. ALL DIMENSIONS MUST BE CHECKED/VERIFIED ON SITE.
  - ANY DISCREPANCIES NOTED ON SITE ARE TO BE REPORTED TO THE ENGINEER IMMEDIATELY.
  - THE LOCATIONS OF ANY KNOWN SERVICES SHOWN ON THIS DRAWING ARE APPROXIMATE AND FOR GUIDANCE ONLY. THE CONTRACTOR WILL CONFIRM THE LOCATION OF ANY SERVICES PRIOR TO THE COMMENCEMENT OF ANY WORKS.
  - THE ELECTRONIC VERSION OF THIS DRAWING IS NOT TO BE USED FOR SETTING OUT.

**REFERENCE DRAWINGS**

19109-JBAI-XX-XX-DR-C-02114 SANDPARK / DÚN AN ÓIR CROSS-SECTIONS

PREFERRED FLUVIAL OPTION			
REPORTING POINT LOCATION	1% AEP FLOOD LEVEL (mOD)	EMBANKMENT LEVEL (mOD)	FLOOD WALL LEVEL (mOD)
P1 (ENTRANCE TO ATLANTIC CULVERT AT WATERWORLD KILKEE)	7.05	-	-
P2 (SANDPARK KILKEE)	9.46	9.86	-
P3 (DÚN AN ÓIR ESTATE)	9.47	-	9.77
P4 (KILKEE BAY HOTEL)	11.24	11.64	-

**LEGEND**

- BOUNDARY WALL LEVEL TO BE RAISED
- NEW FLOOD DEFENCE EMBANKMENT
- WATER LEVEL REPORTING POINT
- STREAM

FINAL DEFENCE LEVELS MAY BE SUBJECT TO MINOR CHANGES DURING THE DETAILED DESIGN PHASE

P03	Comments		FOR PUBLIC CONSULTATION DAY.							
Rev.:	Date	11/04/23	Drawn	PB	Designed	PB	Checked	MOD	Approved	CW
P02	Comments		FOR PUBLIC CONSULTATION DAY.							
Rev.:	Date	07/04/23	Drawn	PB	Designed	PB	Checked	MOD	Approved	CW
P01	Comments		FOR CLIENT REVIEW.							
Rev.:	Date	06/04/23	Drawn	PB	Designed	PB	Checked	MOD	Approved	CW
Client Approval										
A - Approved										
B - Approved with Revisions										
C - Do Not Use										

24 Grove Island  
Cortally  
Limerick  
Ireland  
V94 312N

T +353 (0)61 345 463  
E info@baconsulting.com  
www.baconconsulting.com  
Twitter @JBAConsulting

**DRAFT**

**JBA**  
consulting

Project **KILKEE FLOOD RELIEF SCHEME**

Title **PREFERRED FLUVIAL OPTION  
ATLANTIC STREAM  
SANDPARK KILKEE AND DÚN AN ÓIR ESTATE**

Client **CLARE COUNTY COUNCIL**

The property of this drawing and design vested in Jeremy Benn Associates Ltd. It shall not be reproduced in whole or in part, nor disclosed to a third party, without the prior written consent of Jeremy Benn Associates Ltd.

Drawn:	PB	06/04/2023	Designed:	PB	06/04/2023
Checked:	MOD	06/04/2023	Approved:	CW	06/04/2023
Project Reference:	2019s1431 / CGD		Scale:	1:500 @ A1	
Drawing Number:	19109-JBAI-XX-XX-DR-C-02107		Status:	S3	
			Revision:	P03	
			Sheet Size:	A1	



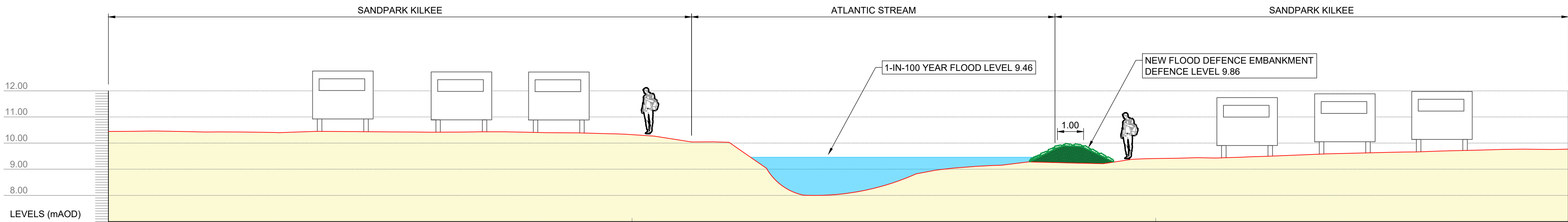

SECTION A-A SANDPARK KILKEE

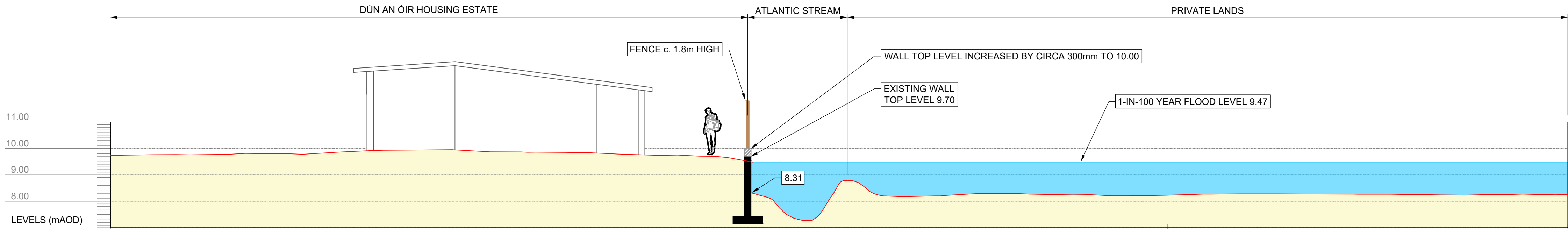

SECTION B-B DÚN AN ÓIR ESTATE

1			
2			
No.	Construction Risk	Maintenance Risk	Demolition Risk
In addition to the hazards/risks normally associated with the types of work detailed on this drawing take note of the above.			

SAFETY, HEALTH AND ENVIRONMENTAL INFORMATION BOX

DRAWING NOTES

- ALL DIMENSIONS SHOWN ARE IN METRES UNLESS OTHERWISE STATED AND LEVELS IN METRES TO ORDNANCE DATUM.
- DO NOT SCALE FROM THIS DRAWING. ALL DIMENSIONS MUST BE CHECKED/VERIFIED ON SITE.
- ANY DISCREPANCIES NOTED ON SITE ARE TO BE REPORTED TO THE ENGINEER IMMEDIATELY.
- THE LOCATIONS OF ANY KNOWN SERVICES SHOWN ON THIS DRAWING ARE APPROXIMATE AND FOR GUIDANCE ONLY. THE CONTRACTOR WILL CONFIRM THE LOCATION OF ANY SERVICES PRIOR TO THE COMMENCEMENT OF ANY WORKS.
- THE ELECTRONIC VERSION OF THIS DRAWING IS NOT TO BE USED FOR SETTING OUT.

CONTAINS IRISH PUBLIC SECTOR DATA (GEOLOGICAL SURVEY IRELAND & THE OFFICE OF PUBLIC WORKS) LICENSED UNDER A CREATIVE COMMONS ATTRIBUTION 4.0 INTERNATIONAL (CC BY 4.0) LICENCE.

REFERENCE DRAWINGS:

19109-JBAI-XX-XX-DR-C-02107 PREFERRED FLUVIAL OPTION SANDPARK/DÚN AN ÓIR

LEGEND

- EXISTING GROUND LEVEL
- PROPOSED GROUND LEVEL
- 1-IN-100 YEAR FLOOD LEVEL

FINAL DEFENCE LEVELS MAY BE SUBJECT TO MINOR CHANGES DURING THE DETAILED DESIGN PHASE

P03	Comments		FOR PUBLIC CONSULTATION DAY.							
Rev.:	Date	11/04/23	Drawn	PB	Designed	PB	Checked	MOD	Approved	CW
P02	Comments		FOR PUBLIC CONSULTATION DAY.							
Rev.:	Date	07/04/23	Drawn	PB	Designed	PB	Checked	MOD	Approved	CW
P01	Comments		FOR CLIENT REVIEW.							
Rev.:	Date	06/04/23	Drawn	PB	Designed	PB	Checked	MOD	Approved	CW
Client Approval										
A - Approved										
B - Approved with Revisions										
C - Do Not Use										

24 Grove Island  
Cortally  
Limerick  
Ireland  
V94 312N

DRAFT

JBA consulting

T +353 (0)61 345 463  
E info@jbaconsulting.com  
www.jbaconsulting.com  
Twitter @JBAConsulting

Project	KILKEE FLOOD RELIEF SCHEME
Title	PREFERRED FLUVIAL OPTION ATLANTIC STREAM SANDPARK / DÚN N ÓIR CROSS-SECTIONS for
Client	CLARE COUNTY COUNCIL

The property of this drawing and design vested in Jeremy Benn Associates Ltd. It shall not be reproduced in whole or in part, nor disclosed to a third party, without the prior written consent of Jeremy Benn Associates Ltd.			
Drawn:	PB	06/04/2023	Designed: PB 06/04/2023
Checked:	MOD	06/04/2023	Approved: CW 06/04/2023
Project Reference:	2019s1431 / CGD	Scale:	1:100 @ A1
Drawing Number:	19109-JBAI-XX-XX-DR-C-02114	Status:	S3
		Revision:	P03
		Sheet Size:	A1



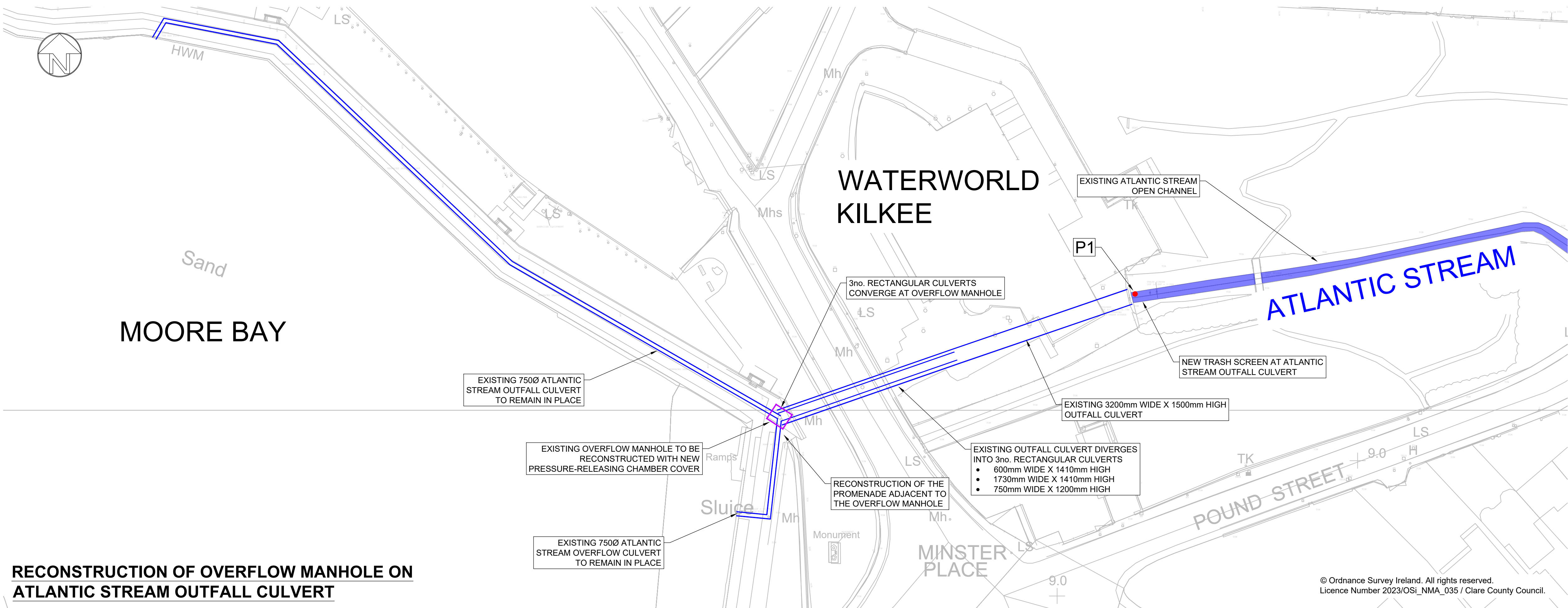

RECONSTRUCTION OF OVERFLOW MANHOLE ON ATLANTIC STREAM OUTFALL CULVERT

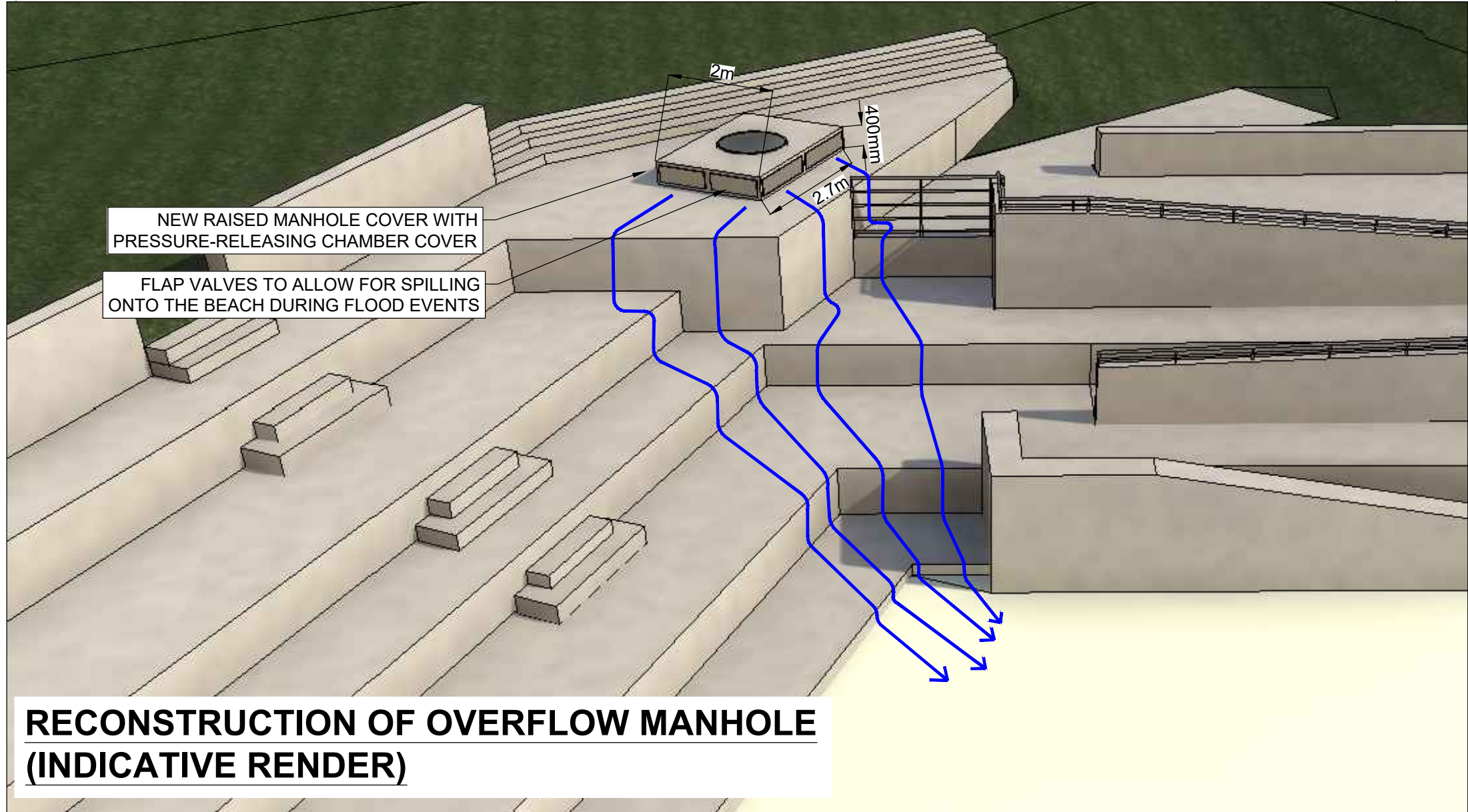

RECONSTRUCTION OF OVERFLOW MANHOLE (INDICATIVE RENDER)

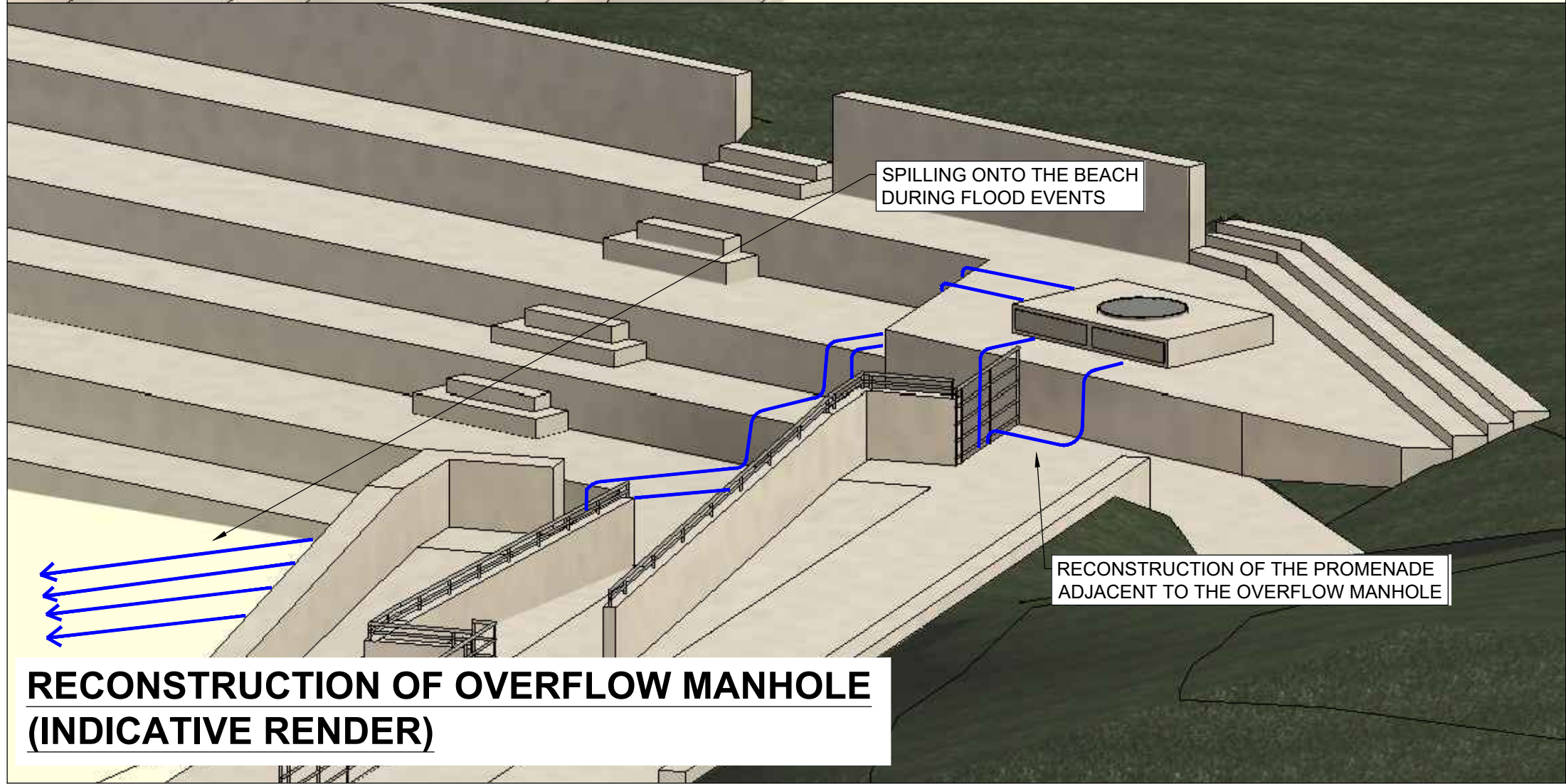

RECONSTRUCTION OF OVERFLOW MANHOLE (INDICATIVE RENDER)



TYPICAL CULVERT WITH NO TRASH SCREEN

INDICATIVE TRASH SCREEN UPGRADE

1			
2			
No.	Construction Risk	Maintenance Risk	Demolition Risk
In addition to the hazards/risks normally associated with the types of work detailed on this drawing take note of the above.			

SAFETY, HEALTH AND ENVIRONMENTAL INFORMATION BOX

- DRAWING NOTES
- ALL DIMENSIONS SHOWN ARE IN METRES UNLESS OTHERWISE STATED AND LEVELS IN METRES TO ORDNANCE DATUM.
  - DO NOT SCALE FROM THIS DRAWING. ALL DIMENSIONS MUST BE CHECKED/VERIFIED ON SITE.
  - ANY DISCREPANCIES NOTED ON SITE ARE TO BE REPORTED TO THE ENGINEER IMMEDIATELY.
  - THE LOCATIONS OF ANY KNOWN SERVICES SHOWN ON THIS DRAWING ARE APPROXIMATE AND FOR GUIDANCE ONLY. THE CONTRACTOR WILL CONFIRM THE LOCATION OF ANY SERVICES PRIOR TO THE COMMENCEMENT OF ANY WORKS.
  - THE ELECTRONIC VERSION OF THIS DRAWING IS NOT TO BE USED FOR SETTING OUT.

PREFERRED FLUVIAL OPTION			
REPORTING POINT LOCATION	1% AEP FLOOD LEVEL (mOD)	EMBANKMENT LEVEL (mOD)	FLOOD WALL LEVEL (mOD)
P1 (ENTRANCE TO ATLANTIC CULVERT AT WATERWORLD KILKEE)	7.05	-	-
P2 (SANDPARK KILKEE)	9.46	9.86	-
P3 (DÚN AN ÓIR ESTATE)	9.47	-	9.77
P4 (KILKEE BAY HOTEL)	11.24	11.64	-

FINAL DEFENCE LEVELS MAY BE SUBJECT TO MINOR CHANGES DURING THE DETAILED DESIGN PHASE

P03	Comments		FOR PUBLIC CONSULTATION DAY.							
Rev.:	Date	11/04/23	Drawn	PB	Designed	PB	Checked	MOD	Approved	CW
P02	Comments		FOR PUBLIC CONSULTATION DAY.							
Rev.:	Date	07/04/23	Drawn	PB	Designed	PB	Checked	MOD	Approved	CW
P01	Comments		FOR CLIENT REVIEW.							
Rev.:	Date	06/04/23	Drawn	PB	Designed	PB	Checked	MOD	Approved	CW
Client Approval										
A - Approved										
B - Approved with Revisions										
C - Do Not Use										

24 Grove Island  
Cortally  
Limerick  
Ireland  
V94 312N

T +353 (0)61 345 463  
E info@jbaconsulting.com  
www.jbaconsulting.com  
Twitter @JBAConsulting

DRAFT



Project

KILKEE FLOOD RELIEF SCHEME

Title

PREFERRED FLUVIAL OPTION  
ATLANTIC STREAM OUTFALL CULVERT

Client

for

CLARE COUNTY COUNCIL

The property of this drawing and design vested in Jeremy Benn Associates Ltd. It shall not be reproduced in whole or in part, nor disclosed to a third party, without the prior written consent of Jeremy Benn Associates Ltd.

Drawn:	PB	06/04/2023	Designed:	PB	06/04/2023
Checked:	MOD	06/04/2023	Approved:	CW	06/04/2023
Project Reference:	2019s1431 / CGD		Scale:	1:500 @ A1	
Drawing Number:	19109-JBAI-XX-XX-DR-C-02105		Status:	Revision:	Sheet Size:
			S3	P03	A1